



Launch area:	Individual launch	Sunrise/Sunset:	6:11:00 AM	15-Jun-2024
Launch period:	Opens at 06:11	Min. ILP → all goals:	1km	
PZs in force:	all active	Next briefing:	5:30	
Solo flight:	not required	QNH	1013	

Task:	19 FIN Fly In (Rule 15.4)	Task order:	in order
a. Position of set goal/target	3495 3439 / 9599	MMA:	Lesser 100m or Conf. of Fid
Scoring period: ends at 07:30	Scoring Method	Marker Color:	Teal
Scoring area: Entire Contest Area	2D/3D	Marker Drop:	Gravity
		Loggermark #:	1

Task:	20 FON Fly On (Rule 15.5)	Task order:	in order
a. Method of declaration (also see Section II.12 and 12.3)	Logger Goal ONE	MMA:	N/A
b. Number of goals permitted	1	Marker Color:	N/A
c. Goals available for declaration	Published list or 4x4 coordinate with altitude.	Marker Drop:	N/A
d. Declaration point requirement	Minimum goal altitude 900' msl	Loggermark #:	2
e. Minimum and maximum distance between declaration point and declared goal(s)	None		
f. Minimum and maximum distances of declared goal(s) from any other targets noted on TDS.	1k min, no Max		
Scoring period: ends at 08:15	1k min, no Max		
Scoring area: Entire Contest Area	Scoring Method		
	3D		

Task:	21 GBM Gordon Bennett Memorial (Rule 15.8)	Task order:	in order
a. Position of goal/target	BILL BUSSEY TASK	MMA:	See Sketch
b. Description of scoring area(s)	3299 3226 / 9945	Marker Color:	Light Blue
Scoring period: ends at 08:30	Inside Race Car - See Sketch (Paper is IN)	Marker Drop:	Free
Scoring area: See Sketch	Scoring Method	Loggermark #:	N/A
	Limited Area		

Task:	22 HWZ Hesitation waltz (Rule 15.3)	Task order:	in order
a. Position of various set goals/targets	3052 / 0204 (near 3002)	MMA:	Lesser 50m or Conf. of Fid
	3102 3169 / 0271	Marker Color:	White
	3103 / 0389	Marker Drop:	Free
Scoring period: ends at 08:45	Scoring Method	Loggermark #:	3
Scoring area: Entire Contest Area	2D/3D		

Task:	23 XDD Maximum Distance Double Drop (Rule 15.18)	Task order:	in order
a. Description of scoring area(s)	See Sketch	MMA:	N/A
	2 Logger marks within scoring area	Marker Color:	N/A
Scoring period: ends at 09:00	Scoring Method	Marker Drop:	N/A
Scoring area: See Sketch	2D	Loggermark #:	4, 5

3299
+

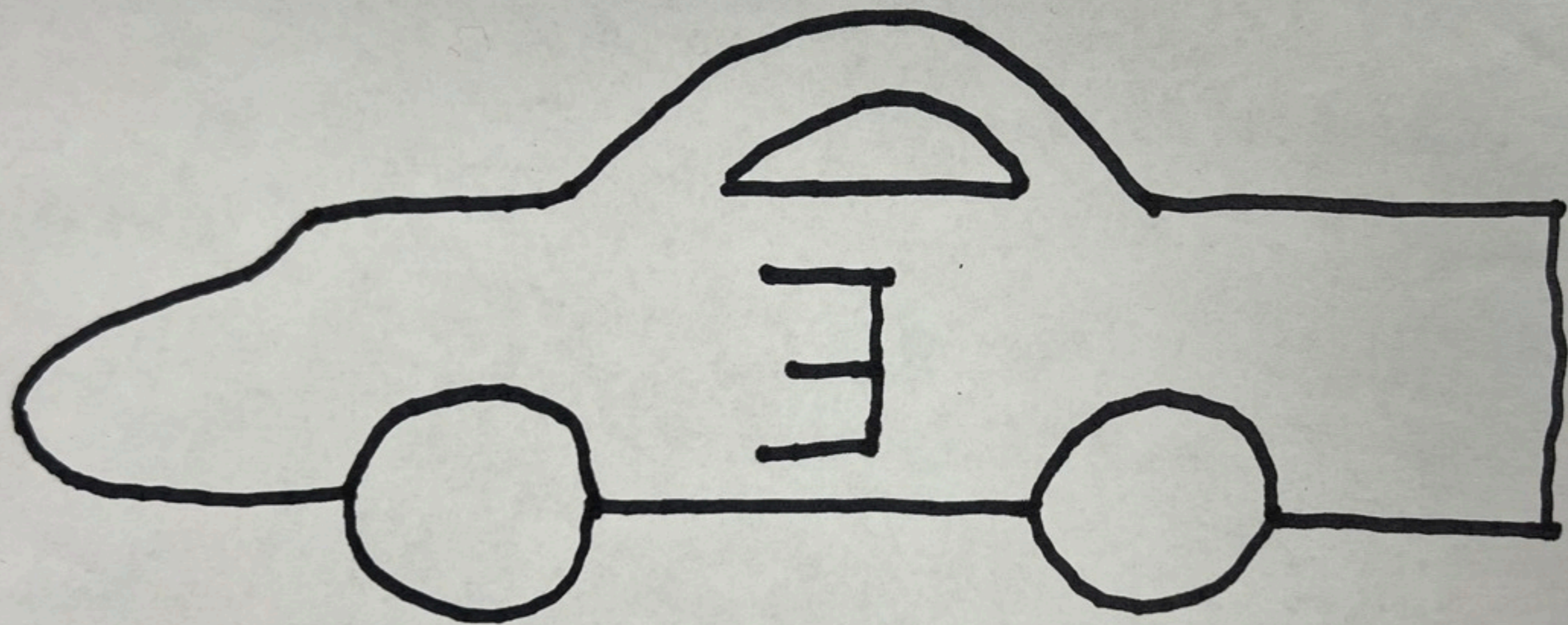

335°
↙

100'

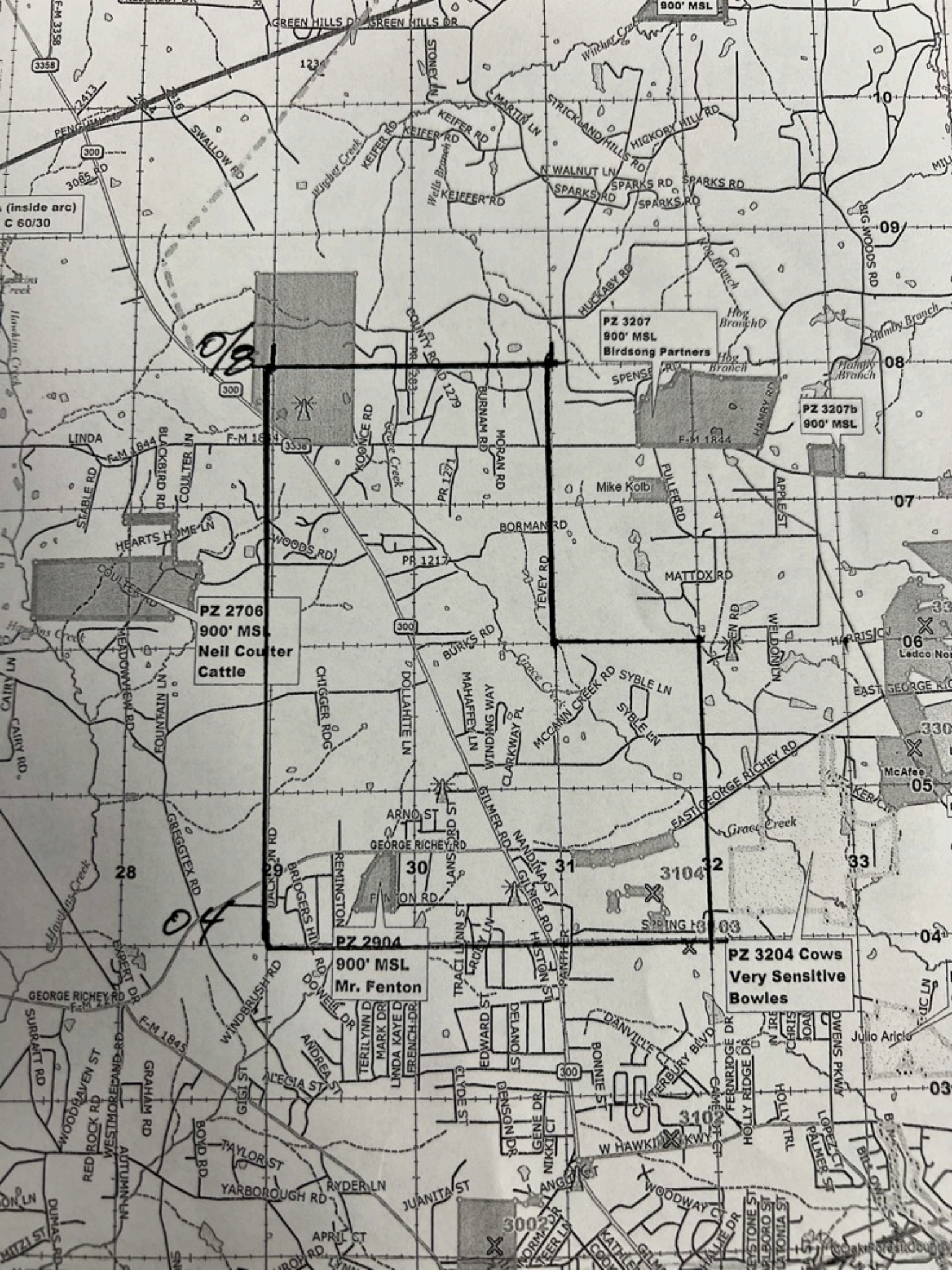

(inside arc)
C 60/30

900' MSL

PZ 2706
900' MSL
Neil Couter
Cattle

PZ 3207
900' MSL
Birdsong Partners

PZ 3207b
900' MSL

PZ 2904
900' MSL
Mr. Fenton

PZ 3204 Cows
Very Sensitive
Bowles

300' MSL